

05/03/2017

Business - Application to vary a premises licence under the Licensing Act 2003

Ref No. 773899

Please enter the name(s) of the premises licence holders who is applying to vary a premises licence under section 34 of the Licensing Act 2003 for the premises described in Part 1 below

	Herne Hill Velodrome Trust
Premises licence number	857807

Non-domestic rateable value of premises in order to see your rateable value click here (opens in new window)

£	25000
---	-------

Postal address of premises or, if none, ordnance survey map reference or description

Address Line 1	HERNE HILL STADIUM
Address Line 2	104 BURBAGE ROAD
Town	LONDON
County	
Post code	SE24 9HE
Ordnance survey map reference	
Description of the location	
Telephone number	██████████

Please select the capacity in which you are applying to convert your existing licence

Daytime contact telephone number	██████████
Email address	██████████
Postal Address if different from premises address	
Town / City	
Postcode	

Do you want the premises licence to have effect as soon as possible?

Please tick	Yes
-------------	-----

If not from what date do you want the variation to take effect?

(DD/MM/YYYY)	
--------------	--

Please describe briefly the nature of the proposed variation (see guidance note 2)

	Updating floor plan to the new Pavilion.
--	--

If 5,000 or more people attend the premises at any one time, please state the number

Please select number from range	Less than 5000
If your proposed variation would mean that 5,000 or more people are expected to attend the premises at any one time. Please state the number expected to attend	

What licensable activities do you intend to carry on from the premises?

	(Please see sections 1 and 14 of the Licensing Act 2003 and schedule 1 and 2 to the Licensing Act 2003)
--	---

Provision of regulated entertainment

Provision of late night refreshment

	i) Late night refreshment
--	---------------------------

Supply of alcohol

	j) Supply of alcohol
--	----------------------

Will the provision of late night refreshment take place indoors or outdoors or both? (Please read guidance note 3)

	Indoors
--	---------

Please give further details here (Please read guidance note 4)

	Snacks provided over the counter.
--	-----------------------------------

Standard days & timings for Late night refreshment (Late night start time is from 23.00, see guidance notes 7)

Day	Start	Finish
Mon	23:00	23:30
Tues	23:00	23:30
Wed	23:00	23:30
Thur	23:00	23:30
Fri	23:00	23:30
Sat	23:00	23:30
Sun	23:00	23:30

State any seasonal variations for the provision of late night refreshment (Please read guidance note 5)

--	--

Non standard timings. Where you intend to use the premises for the provision of late night refreshment at different times, to those listed. Please list, (Please read guidance note 6)

--	--

Will the supply of alcohol be for consumption (Please read guidance note 8)

	Both
--	------

Standard days and timings for Supply of alcohol (Please read guidance note 7)

Day	Start	Finish
Mon	10:00	23:00
Tues	10:00	23:00
Wed	10:00	23:00
Thur	10:00	23:00
Fri	10:00	23:00
Sat	10:00	23:00
Sun	12:00	10:30

State any seasonal variations for the supply of alcohol (Please read guidance 5)

--	--

Non standard timings. Where you intend to use the premises for the supply of alcohol at different times to those listed. Please list, (Please read guidance note 6)

--	--

Please highlight any adult entertainment or services, activities, other entertainment or matters ancillary to the use of the premises that may give rise to concern in respect of children (Please read guidance note 9)

	None
--	------

Hours premises are open to the public (standard timings Please read guidance note 7)

Day	Start	Finish
Mon	10:00	23:00
Tues	10:00	23:00
Wed	10:00	23:00
Thur	10:00	23:00
Fri	10:00	23:00
Sat	10:00	23:00
Sun	12:00	22:30

State any seasonal variations (Please read guidance note 5)

	None
--	------

Non standard timings. Where you intend to use the premises to be open to the public at different times from those listed. Please list, (Please read guidance note 6)

--	--

Please identify those conditions currently imposed on the licence which you believe could be removed as a consequence of the proposed variation you are seeking.

	We are not seeking to change any of our conditions.
--	---

a) General - all four licensing objectives (b,c,d,e) (Please read guidance note 10)

	We propose to take on all conditions from the previous license.
--	---

b) the prevention of crime and disorder

	We propose to take on all conditions from the previous license.
--	---

c) public safety

	We propose to take on all conditions from the previous license.
--	---

d) the prevention of public nuisance

	We propose to take on all conditions from the previous license.
--	---

e) the protection of children from harm

	We propose to take on all conditions from the previous license.
--	---

If the plan of the premises are varying please upload a plan of the premises,

Upload proposed plans	HHV-3032-Rev-Q-Pavilion-First-Floor-Plan-RECORD-DRAWING.pdf
Upload existing plans	

Checklist

	I understand that I must now advertise my application. I understand that if I do not comply with the above requirements my application will be rejected.
--	---

I agree to the above statement

	I agree
PaymentDescription	200003450927, ,
AuthCode	003909
LicenceReference	LPV-94212-58
PaymentContactEmail	

Please provide name of applicant (the current premises licence holder) or applicant's solicitor or other duly authorised agent (please read guidance note 12). If completing on behalf of the applicant, please state in what capacity.

Full name	Phillip Wright
Date (DD/MM/YYYY)	03/03/2017
Capacity	Herne Hill Velodrome Trust Trustee

Where the premises licence is jointly held, please enter the 2nd applicants name (the current premises licence holder) or 2nd solicitor or other authorised agent (please read guidance note 13). If completing on behalf of the applicant, please state i

Full name	
Date (DD/MM/YYYY)	
Capacity	

Contact name (where not previously given) an address for correspondence associated with this application (please read guidance note 14)

Contact name and address for correspondence	Chris Lucas
Telephone No.	██████████
If you prefer us to correspond with you by e-mail, your email address (optional)	██████████

The information you provide will be used fairly and lawfully and Southwark Council will not knowingly do anything which may lead to a breach of the Data Protection Act 1998.

General Notes:

Any discrepancies between drawings to be reported to the Architect immediately.

All Levels are above Ordnance Datum (AOD)

New Levels are shown thus: 20.345

Existing Levels are shown thus: 20.345

Retained Existing Levels: EX-20.345

Use figured dimensions only. Do not scale from drawings. IF IN DOUBT, ASK

Refer to Structural Engineers drawings for all structural and services information.

For tolerances see the Design Drawings and Specifications

For elements of work subject to Contractor's Design, this drawing is indicative of the visual & performance requirements only. The Contractor is responsible for the detailed design and co-ordination of the installation within the parameters defined in the specification, design drawings, contract terms and contract documents.

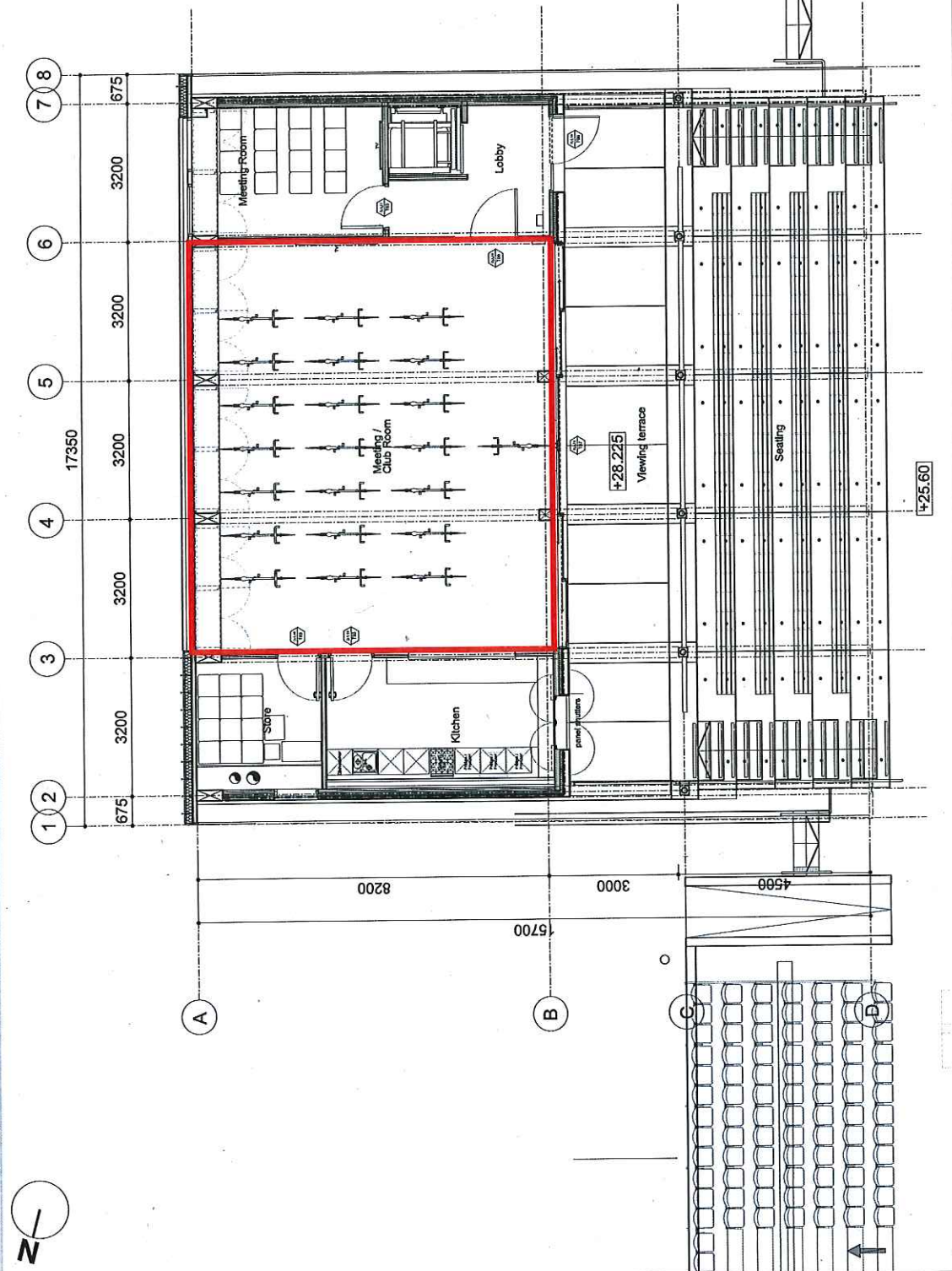

RECORD

Scale at 1:100 (A3)



Date	Rev.	Description	Approved By	Project	Subject	Architects	Date	Scale	Sort Code	Drawing Number	Rev.
16.03.2015	J	Issued under IN: 0015 revised drawings for planning application - addition of scale bar and sheet annotation	TK	Heme Hill Velodrome	Proposed Pavilion Scheme	Hopkins Architects Partnership LLP	14.05.2014	1:100 at A3	A/HVN	3032	Q
24.07.2015	K	Coordination Issue	MT			27 Broadley Terrace, London, NW1 6LG					
31.07.2015	L	Stage D Issue	MT			T: 020 7724 1751 E: mail@hopkins.co.uk					
07.08.2015	M	Stage D Tender Issue	MT								
08.04.2016	N	Issued under IN: 0022 for Construction	TK								
07.10.2016	P	Updated to show HESS CLT sizes and furniture layout	TK								
27.07.2017	Q	Record Drawing Issued Under Memo 0119	TK								